



# Cube

## VCMS 24

inch 24 x 18 x 2 mm 610 x 457 x 51

■ **interior dimensions**

inch 16 x 11.5 x 3.375 mm 406 x 292 x 86

■ **weight**

lb - 16 kg - 7

■ **installation**

semi-recessed

■ **accessory**

nil

■ **overflow**

without overflow : VCMS 24  
 built-in overflow : VCMS 24-O  
 polished chrome or brushed nickel

■ **faucet hole**

mono, 8" c/c, no hole  
 or custom drillings

■ **material**

WETMAR BIO™, True High Gloss™  
 or matte finish

■ **color**

white

■ **codes/standards applicable**

IAPMO-ANSI Z124.1 – IAPMO-ANSI Z124.3  
 CSA B 45.0 – CSA B45.4

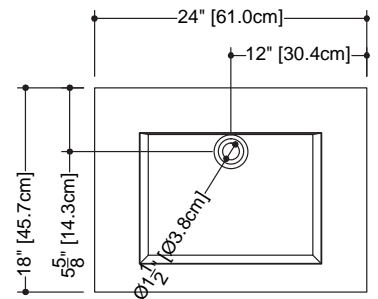
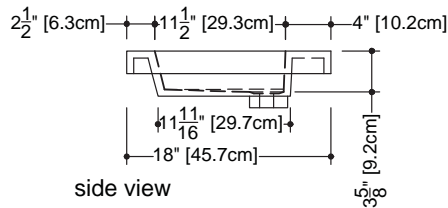
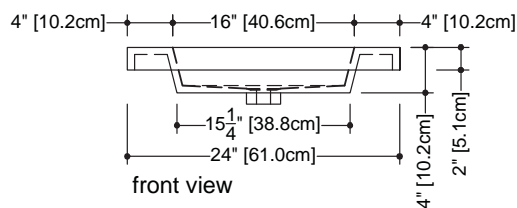

WETSTYLE cannot be held responsible for any technical errors and reserves the right to make revisions without notice.

Approximate measurement.  
 The manufacturer accept 1/4" (6.35mm) variance.

www.WETSTYLE.CA - Montreal - Canada  
 Tel. 450.536.9000 - 1 888.536.9001 - Fax. 450.536.0202

